

## 2.2 TURNING VANE SYSTEM

### 2.2.3 MEZ-PILZ

- Fastener for partition plates, turning vanes and valve blades
- For sheet thickness till 1.75 mm
- High quality steel, electro galvanised

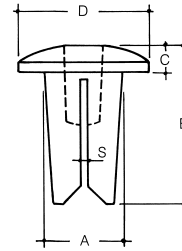

Art.-Nr.	Material	for metal sheets mm	A	B	C	D	E	VPE units	Weight kg/unit
300	Galv. steel	0,40 - 0,90	8,6	15,5	3,4	15,0	0,9	1.000	0,0069
301	Galv. steel	0,60 - 1,25	9,6	19,0	4,0	18,0	1,0	1.000	0,0100
302	Galv. steel	1,25 - 1,75	12,0	24,0	4,0	20,0	1,5	1.000	0,1700
302 E	Stainless steell*	1,25 - 1,75	12,0	24,0	4,0	20,0	1,5	1.000	0,1700

\* on request

#### Stress details:

Turning vane thickness mm	Extraction values kN/unit (Breaking load)		
	Art.-Nr. 300	Art.-Nr. 301	Art.-Nr. 302
0,63	0,563	0,747	-
0,75	1,757	1,350	-
0,88	1,913	1,973	-
1,00	-	2,347	-
1,13	-	2,756	-
1,25	-	2,857	3,140
1,50	-	-	2,616
1,75	-	-	2,092

#### Example highlighting the stress factor:

With duct wall  $1\text{ m}^2$  / turning vane thickness 1.0 mm, MEZ-PILZ 5 units = Breaking load 11.9 kN and with a pressure of 1000 Pa ( $1.0\text{ kN/m}^2$ ) – a minimum ten fold security is guaranteed.

### CENTRE DRILL

- For MEZ-PILZ
- With centre point for precise drilling

Art.-Nr.	Operate Ø mm	To product Art.-Nr.	VPE units	Weight kg/unit
710	8,0	300	1	0,0250
711	9,0	301	1	0,0250
712	11,5	302	1	0,0250
715	10,5	313	1	0,0250
721	9,5		1	0,0250

